

Patent #'s
 US 9,874,018
 US 9,909,309
 US 9,920,532
 US 9,797,140
 US 9,777,531
 US 9,598,867
 US 9,441,378

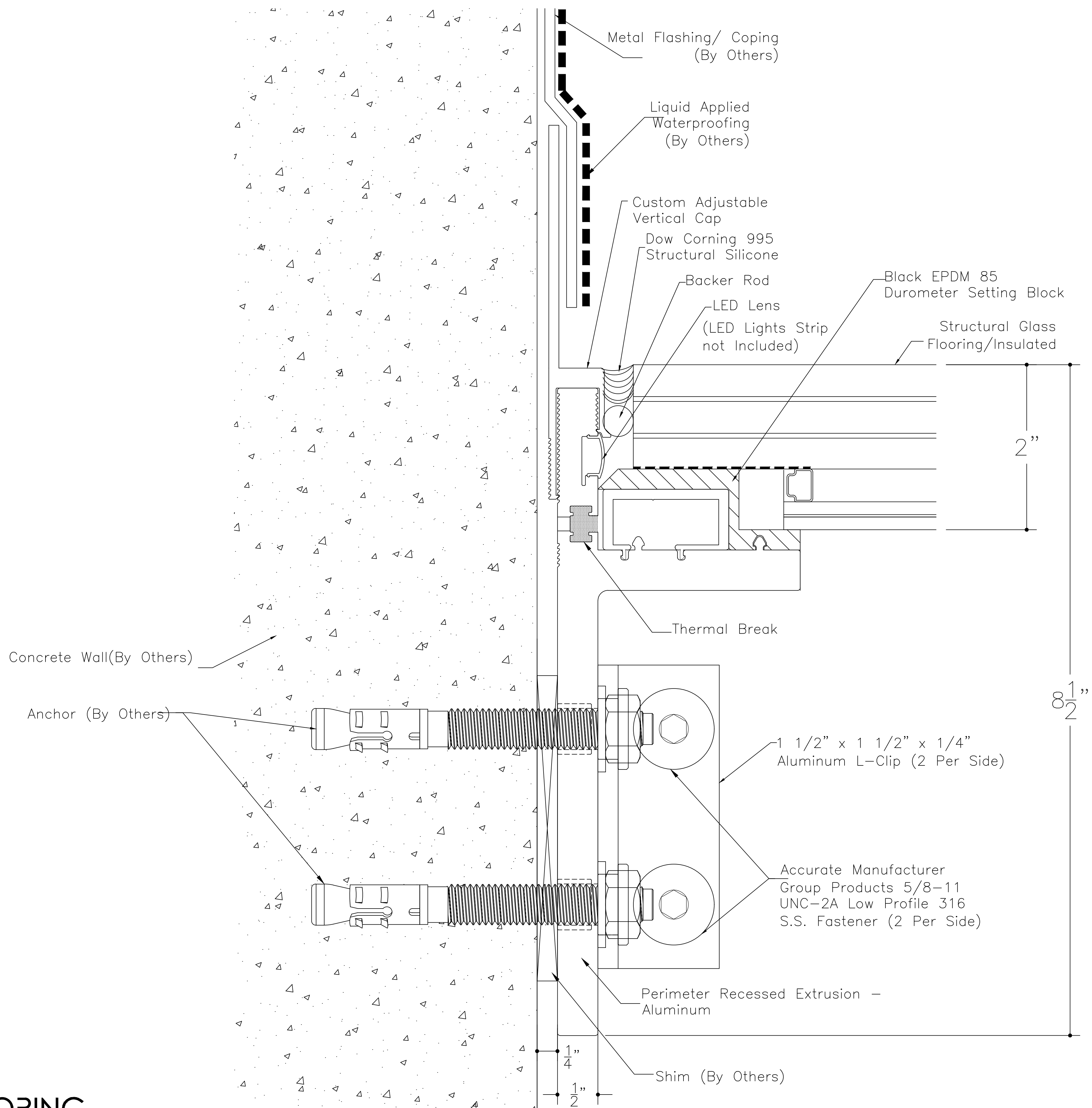

SkyFloor® Series 1000 Exterior Recessed Paver Detail with Concrete Wall- Rear Flange Off



| | | | |
|--|----------|---|--------|
| ARCHITECT | | | |
| CONTRACTOR | | | |
| MANUFACTURER | | Glass Flooring Systems, Inc. 6 Aaron Way Sparta, NJ 07871 | |
| PROJECT | | SkyFloor® Series 1000 Exterior Walkable Skylight Recessed Details with Concrete Wall -Rear Flange Off | |
| SCALE: N.T.S. ALL ELEVATIONS ARE VIEWED FROM EXTERIOR | | | |
| DRAWN | DATE | DWG NO. | SHEET |
| GFS | 12/12/25 | Recessed TB | 1 OF 1 |